

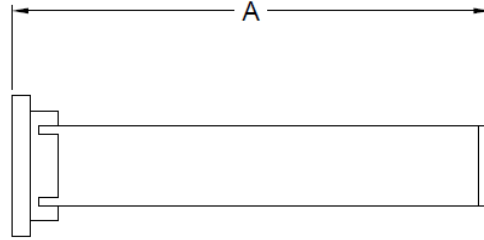

Medium-Low Power Termination Description

- Operating Frequency 2.60– 50.00 GHz
- Full band VSWR 1.10:1 MAX
- Power Handling 20 to 600 WATTS
- Waveguide Is Standard Copper/Brass or Aluminum (6061)
- Pressurized
- Finish: High Temperature Flat Black*
- RoHS Compliant



Waveguide Flanges:

1. Cover
2. Choke
3. CPRF
4. CPRG
5. CMR
6. Cover Grooved
7. CAR
8. PAR
9. UAR
10. CBR
11. PBR
12. UBR
13. UDR
14. RDR
15. PDR

P/N	WR Size	Freq. (GHz)	Power Handling (W)	Dim "A" (in)
2448	22	33.00 - 50.00	20	2.00
2449	28	22.00 - 40.00	50	4.00
2450	42	18.00 - 26.50	75	3.75
2452	51	15.00 - 22.00	75	3.75
2400	62	12.40 - 18.00	100	4.00
2400	75	10.00 - 15.00	125	5.00
2400	90	8.20 - 12.40	175	6.00
2453	102	7.00 - 11.00	200	6.50
2702	112	7.05 - 10.00	150	5.00
2465	137	5.85 - 8.20	250	7.50
2451	159	4.90 - 7.05	325	6.00
2154	187	3.95 - 5.85	375	8.50
2455	229	3.30 - 4.90	500	10.00
2456	284	2.60 - 3.95	600	11.50

Special Flange List as: FSXX

Part Number Example: 2449-1A

P/N	Flange	Material A=Aluminum B=Brass
2449	1	A

*Other finishes are available upon request

Data Sheet T3 r1