

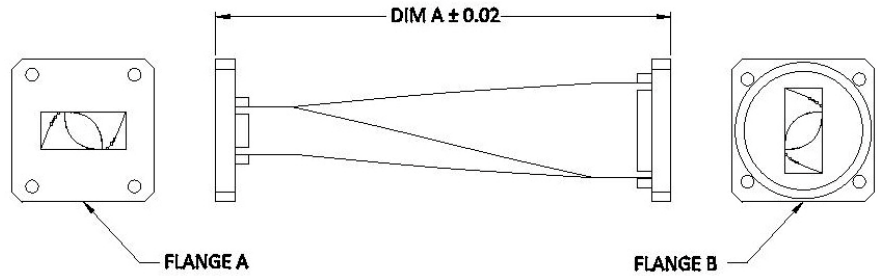

### Waveguide Twist Assembly Description

- Operating Frequency's: 1.12-50.0 GHz
- Waveguide is Standard Material OFHC Copper or Aluminum (6061)
- Custom Lengths to Customer Specifications
- \*Finish: High Temperature Flat Black, RoHS Compliant
- Pressurization 5 PSIG
- VSWR 1.10:1 max.



#### Waveguide Flanges:

1. Cover
2. Choke
3. CPRF
4. CPRG
5. CMR
6. Cover Grooved
7. CAR
8. PAR
9. UAR
10. CBR
11. PBR
12. UBR
13. UDR
14. RDR
15. PDR

| WR SIZE | FREQ. (GHz)   | DIM "A" MIN |
|---------|---------------|-------------|
| 22      | 33.00 - 50.00 | 1.50        |
| 28      | 26.50 - 40.00 | 1.50        |
| 34      | 22.00 - 33.00 | 1.50        |
| 42      | 18.00 - 26.50 | 1.50        |
| 51      | 15.00 - 22.00 | 2.00        |
| 62      | 12.40 - 18.00 | 3.00        |
| 75      | 10.00 - 15.00 | 3.00        |
| 90      | 8.20 - 12.40  | 4.00        |
| 102     | 7.00 - 11.00  | 4.00        |
| 112     | 7.05 - 10.00  | 5.00        |
| 137     | 5.85 - 8.20   | 6.00        |
| 159     | 4.90 - 7.05   | 7.00        |
| 187     | 3.95 - 5.85   | 8.00        |
| 229     | 3.30 - 4.90   | 10.00       |
| 284     | 2.60 - 3.95   | 12.00       |
| 340     | 2.10 - 3.00   | 18.00       |
| 430     | 1.70 - 2.60   | 20.00       |
| 510     | 1.45 - 2.20   | TBD         |
| 650     | 1.12 - 1.70   | TBD         |

Special Flange List as: FSXX

Part Number Example: 3350-112-1-2-6.00-A

| P/N   | Waveguide Size | Flange Type "A" | Flange Type "B" | Dim "A" (Inches) | Material<br>A=Aluminum<br>B=Brass/Copper |
|-------|----------------|-----------------|-----------------|------------------|--|
| 3350- | 112            | 1               | 2               | 6.00             | A  |

\*Other finishes available upon request

This configuration is made up of: WR-112, cover flange, choke flange, 6.00" in A DIM, and made out of aluminum flanges and waveguide